

LEVEL 6

PH4



PENTHOUSE - 4 (LEVEL- 6)

	AREA SQ.M.	AREA SQ.FT.
BUILT UP AREA	111.6	1201
TERRACE & BALCONIES	22.0	237
GROSS FLOOR AREA	133.6	1438

LEVEL 7

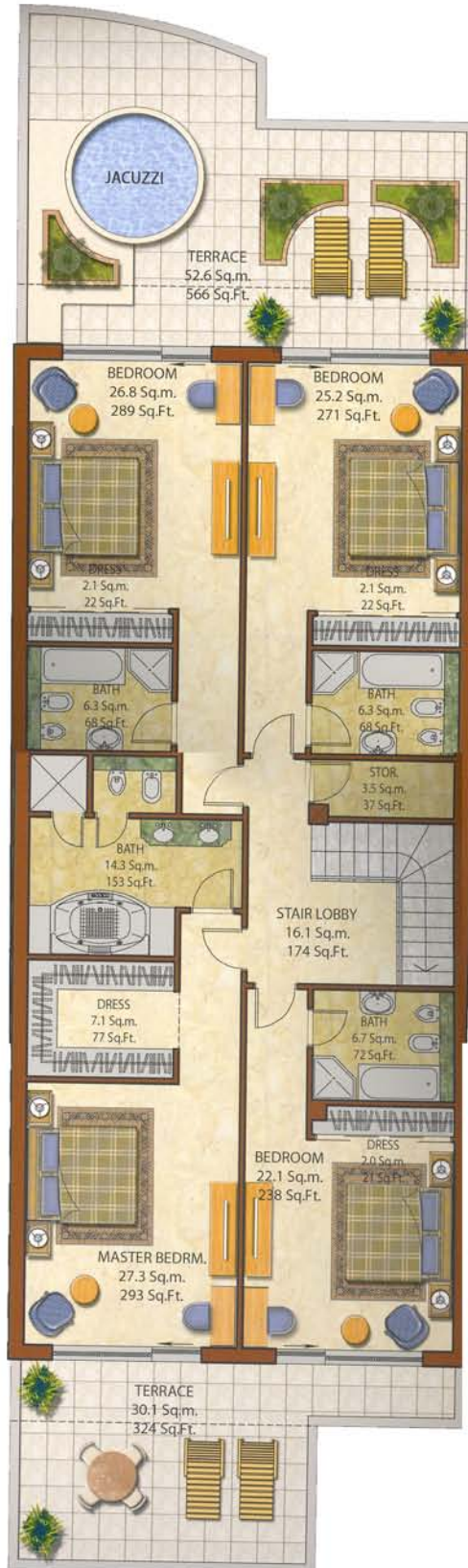

TOTAL PH-4 (LEVELS 6 & 7)		
	AREA SQ.M.	AREA SQ.FT.
BUILT UP AREA	303.2	3264
TERRACE & BALCONIES	104.7	1127
GROSS FLOOR AREA	407.8	4389